

Wall Mount

Product Outline

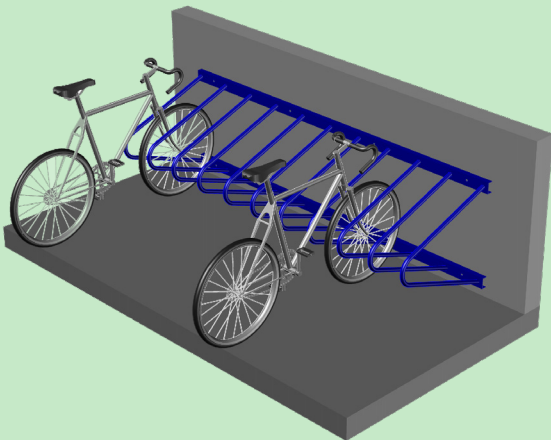
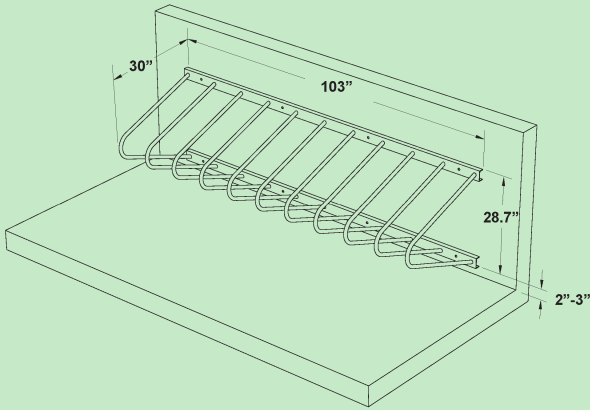

Parking Capacity

10 

Materials

1.0" OD

Finishes

 Powder Coat (over high strength steel)
Electrostatically applied powder finish over zinc-rich primer.

 Stainless Steel
304 grade stainless steel with varying surface finishes available from gloss to satin.

Mounting Options

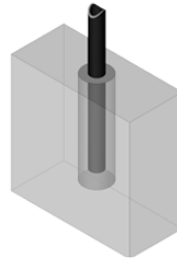

 In-ground

- Embedded in concrete footings
- Detailed instruction provided for each rack

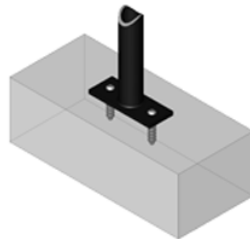

 Surface

Base plates are anchored directly to the concrete using tamper proof anchors. Greenspoke includes the hardware required but there are several other hardware options also available. Typical anchor hardware:
1/2" security bolt
1/2" drop-in anchor (with setting tool)