

# Scooter Rack

## Product Outline

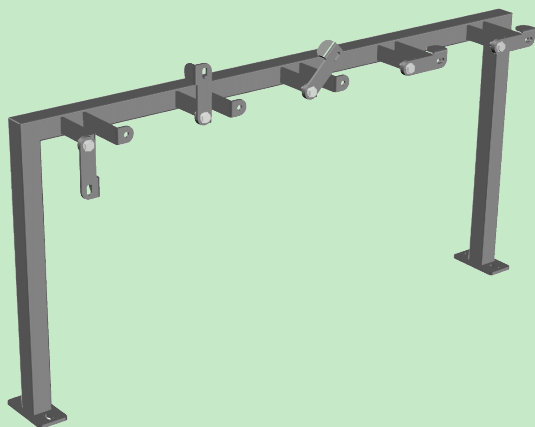

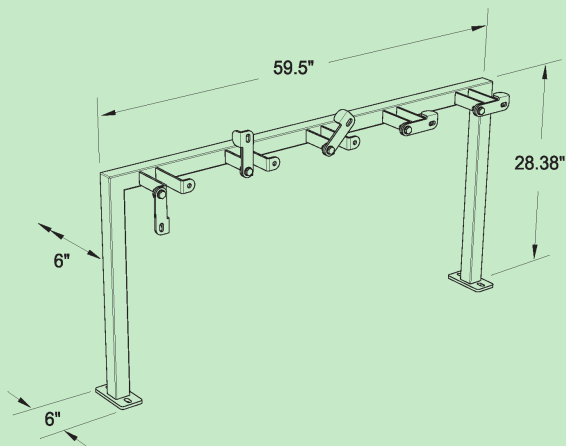

### Parking Capacity

5 

### Materials

2" Wall

### Finishes

-  **Powder Coat** (over high strength steel)  
Electrostatically applied powder finish over zinc-rich primer.
-  **Stainless Steel**  
304 grade stainless steel with varying surface finishes available from gloss to satin.

### Mounting Options

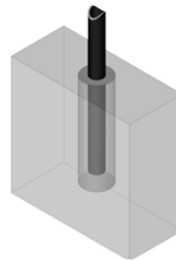

-  **In-ground**
  - Embedded in concrete footings
  - Detailed instruction provided for each rack

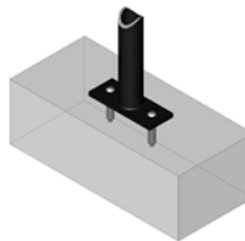

-  **Surface**

Base plates are anchored directly to the concrete using tamper proof anchors. Greenspoke includes the hardware required but there are several other hardware options also available.

Typical anchor hardware:  
1/2" security bolt  
1/2" drop-in anchor (with setting tool)