

4-Way Hanger

Product Outline

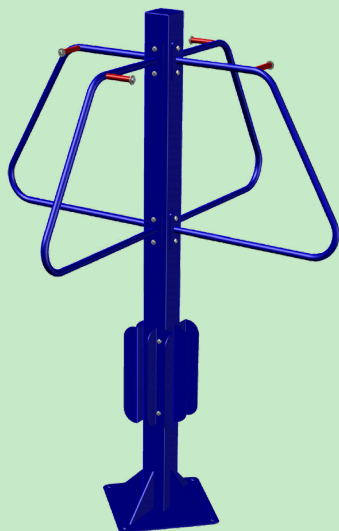
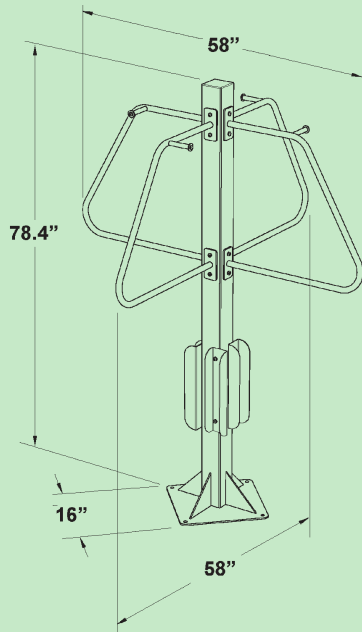

Parking Capacity

4 

Materials

1.0" OD

Finishes

 **Powder Coat** (over high strength steel)
Electrostatically applied powder finish over zinc-rich primer.

 **Stainless Steel**
304 grade stainless steel with varying surface finishes available from gloss to satin.

Mounting Options

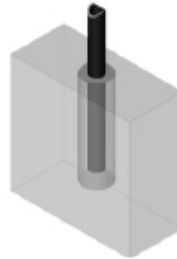

 **In-ground**

- Embedded in concrete footings
- Detailed instruction provided for each rack

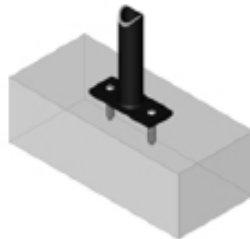

 **Surface**

Base plates are anchored directly to the concrete using tamper proof anchors. Greenspoke includes the hardware required but there are several other hardware options also available.

Typical anchor hardware:
1/2" security bolt
1/2" drop-in anchor (with setting tool)