

Top View

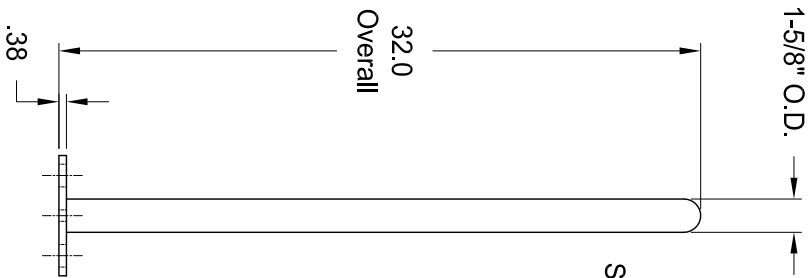

**GREENSPOKE**  
BIKE PARKING SOLUTIONS

1-844-888-9999  
www.gogreenspoke.com



Side View

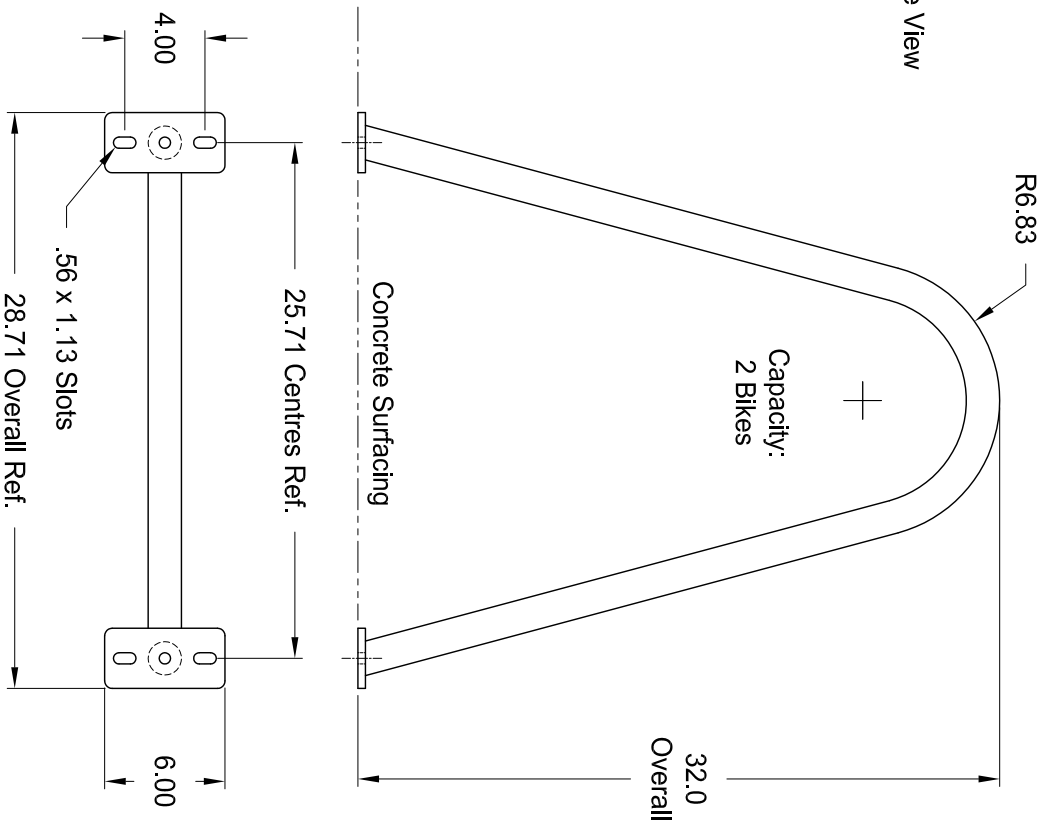

**Materials:**

1.66" O.D. x .125" Wall, Steel Tube  
3/8" Thick Steel (Base Plates)  
(Note: Anchoring Hardware Not Included)

**Peak Bike Rack**  
Surface Mounting  
- Specifications -  
Model: **850298**

Rev.: 30Jun16

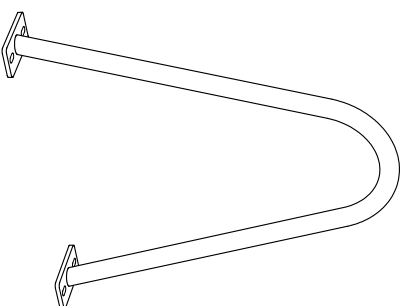

**Finishes:**

- 1) Polyester Powder over Zinc Rich Primer.
- 2) Hot Dip Galvanized.

Dimensions shown are in inches.

Greenspoke maintains a policy of continuous product improvement. As a result, some details may change without notice.