

**Model: 850060**  
2-Hump, Surf. Mtg.

Capacity:  
**3 to 5 Bikes**

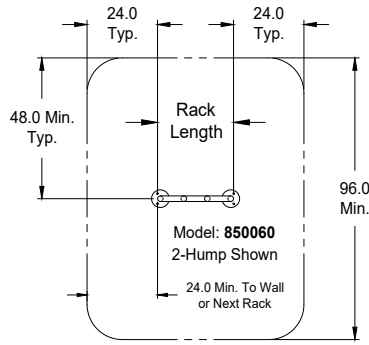
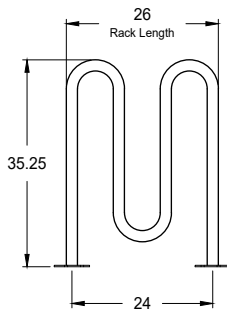

**Typical Suggested  
Clearance Zone**  
¼ Scale

**Model: 850080**  
3-Hump, Surf. Mtg.

Capacity:  
**5 to 7 Bikes**

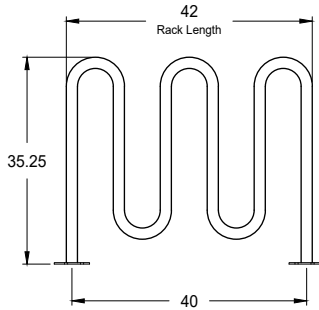

**Model: 850090**  
4-Hump, Surf. Mtg.

Capacity:  
**7 to 9 Bikes**

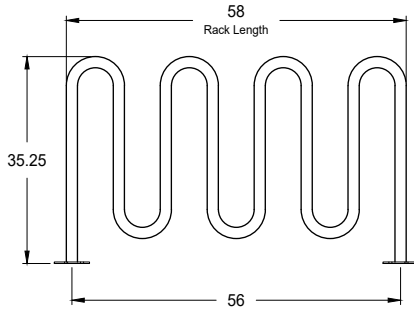

**Model: 850100**  
5-Hump, Surf. Mtg.

Capacity:  
**9 to 11 Bikes**

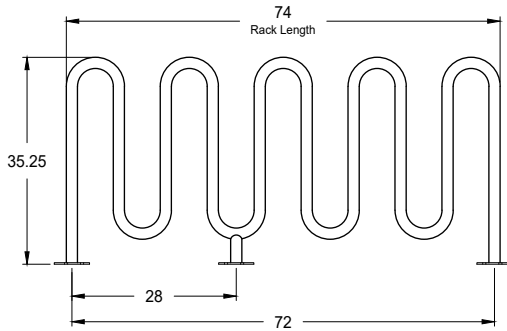

**Model: 850106**  
6-Hump, Surf. Mtg.

Capacity:  
**11 to 13 Bikes**

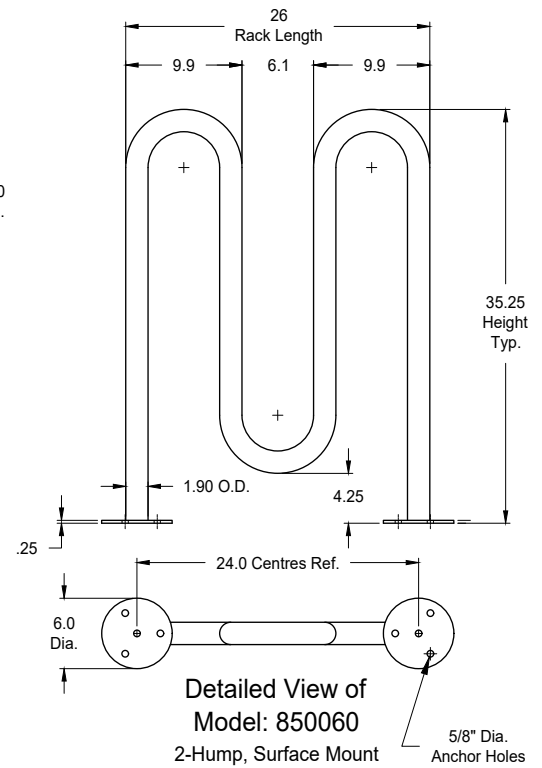
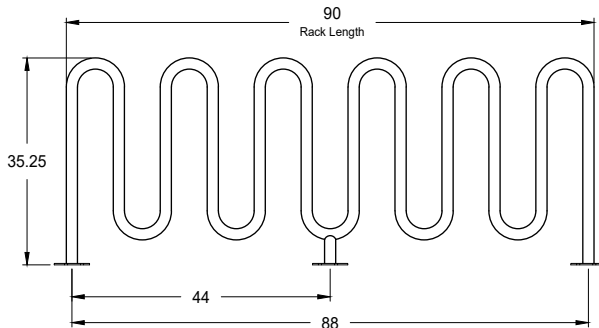

#### Materials:

Tube: 1.90" O.D. x .125" Wall HS Steel

Base/Mounting Plates: 1/4" Thick x 6" Dia. Steel

Note: Anchoring Hardware Available Upon Request.

#### Available Finishes:

- 1) Polyester Powder over Zinc Rich Primer.
- 2) Hot Dip Galvanized.

Dimensions shown are in inches.

Greenspoke maintains a policy of continuous product improvement.  
As a result, some details may change without notice.

#### Bi-Directional Parking Space Required

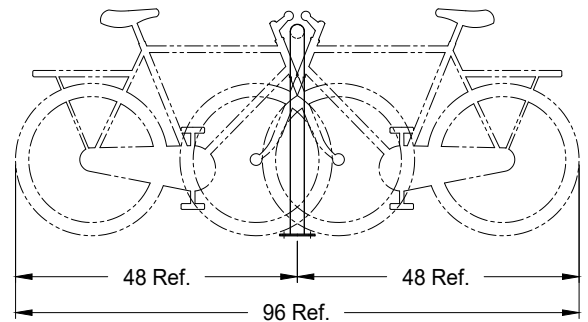

#### Uni-Directional Parking Space Required

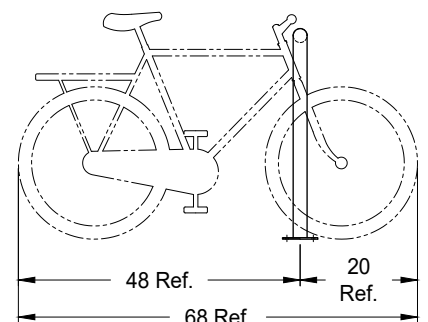

## M-Racks

2 to 6 Hump, Surface Mount

### - Specifications -

Rev.: 26Jul24



**GREENSPOKE**  
BIKE PARKING SOLUTIONS

1-844-888-9999  
www.gogreenspoke.com