

RP-V1 Repair Post

Product Outline

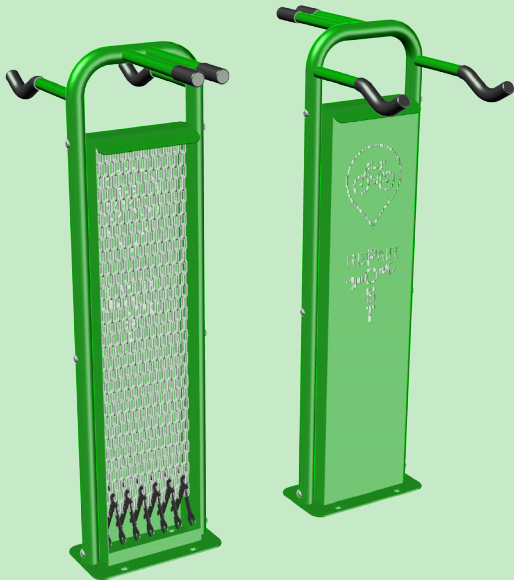

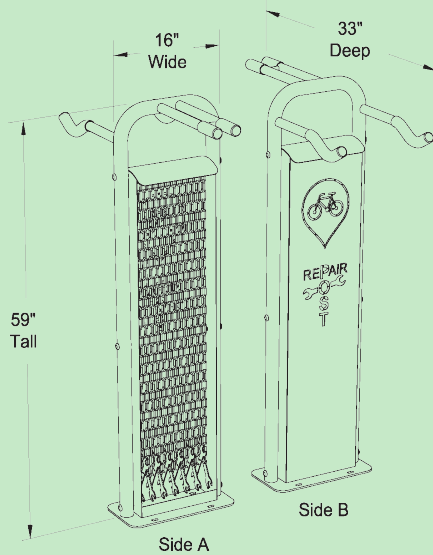

Fix



Materials

2.375" OD

Finishes

-  **Powder Coat**
 1. Sandblast raw product.
 2. Spray statically charged powder evenly around the bike rack.
 3. Cook in a powder coat oven at 350°-375°F, this allows the powder coated paint to liquify and cure to the product.
-  **Stainless Steel**

304 grade stainless steel finished in varying degrees of shine or satin.

Mounting Options

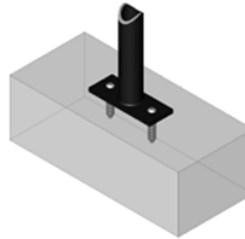

-  **Surface**

Base plates are anchored to the concrete using secure anchors. Greenspoke includes the general hardware required but there are several other hardware options also available.